

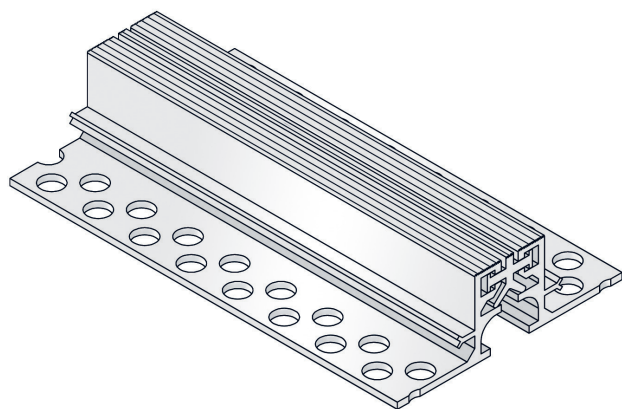

AL.5.45/..

- for medium loads
- three-dimensional absorption of movements
- anti-slip surface
- solid full-aluminium structure



FEATURES

resistant to heavy loads, trafficable by fork-lift trucks, punched bearing legs guarantee best connection to the subgrade/covering.

APPLICATIONS

all industrial applications, shopping centres, railway stations, airports, exhibition halls

MATERIAL

aluminium

COVERING TYPES

coating, concrete, screed, industrial covering, natural and stone slabs

TRAFFICABILITY

industrial trucks (lifting trucks, fork-lifts etc.), passenger car, trucks

FORMED PARTS

corner piece, T piece, cross piece

NOTES

We recommend that the customer applies grout between profile and covering so as to avoid typical hairline cracks.

Technical data

Movement horizontal:	10 mm (± 5 mm)
Movement vertical:	6 mm (± 3 mm)
Visible width:	45 mm
Maximal joint width:	35 mm
Load rating:	wheel load 1500 kg up to \varnothing 150 mm, B = 100 mm
Load rating trucks:	600 kN (DIN 1072)
Load rating forklifts:	100 kN (DIN 1055-3)
Supply length:	3 mtr

Designs

Article No.	Profile height (h)	Recess (WxD)
AL.5.45/35	35 mm	200 x 45 mm
AL.5.45/50	50 mm	200 x 60 mm

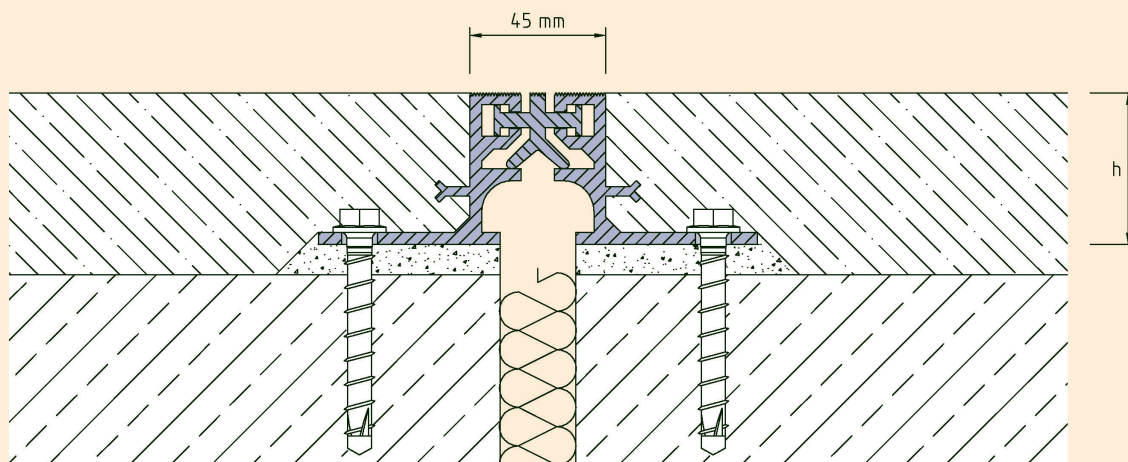

AL.5.45

Subject to technical change without notice.