

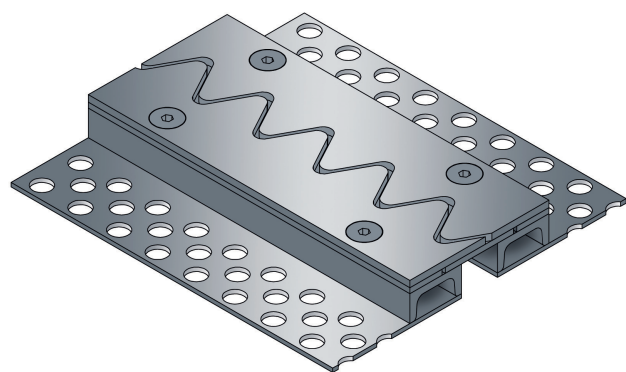

ST.6.110/..

- for heavy loads
- vibration-free trafficability



FEATURES

resistant to heavy loads, trafficable by fork-lift trucks, punched bearing legs guarantee best connection to the subgrade/covering.

APPLICATIONS

all industrial applications, areas with use of driverless vehicular systems, shopping centres, railway stations, airports, exhibition halls

MATERIAL

black steel

COVERING TYPES

coating, concrete, screed, industrial covering, natural and stone slabs

TRAFFICABILITY

industrial trucks (lifting trucks, fork-lifts etc.), passenger car, trucks

FORMED PARTS

corner piece, T piece, cross piece, transition floor to wall

NOTES

We recommend that the customer applies grout between profile and covering so as to avoid typical hairline cracks.

Technical data

Movement horizontal:	13 mm (-5/+8 mm)
Visible width:	108 mm
Maximal joint width:	30 mm
Load rating:	wheel load 5000 kg up to Ø 150 mm, B = 100 mm
Load rating trucks:	600 kN (DIN 1072)
Load rating forklifts:	150 kN (DIN 1055-3)
Supply length:	3 mtr

Designs

Article No.	Profile height (h)	Recess (WxD)
ST.6.110/32	31 mm	270 x 41 mm
ST.6.110/47	46 mm	270 x 56 mm
ST.6.110/62	61 mm	270 x 71 mm
ST.6.110/77	76 mm	270 x 86 mm
ST.6.110/92	91 mm	270 x 101 mm
Special heights on request.		

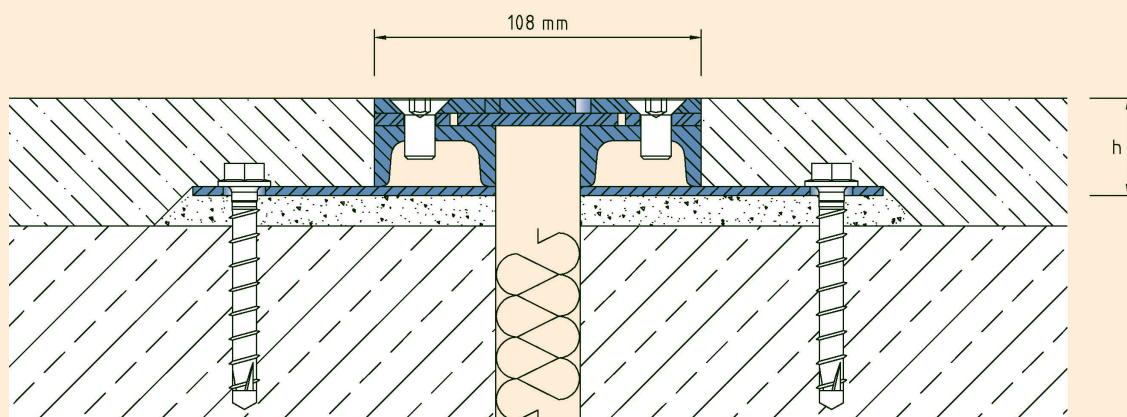

ST.6.110

Subject to technical change without notice.