

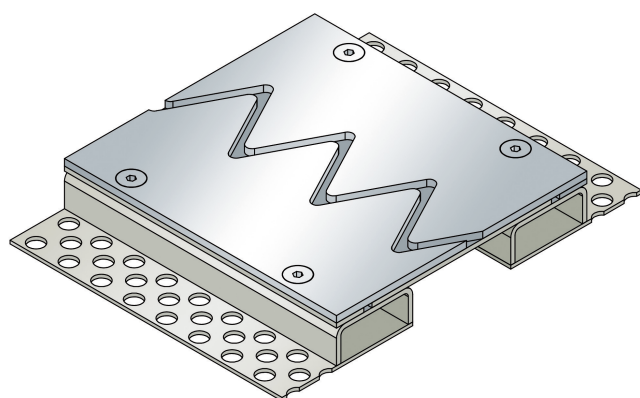

VA.6.230/..

- for heavy loads
- vibration-free trafficability
- visible surface in high-grade steel



FEATURES

resistant to heavy loads, trafficable by fork-lift trucks, punched bearing legs guarantee best connection to the subgrade/covering.

APPLICATIONS

all industrial applications, areas with use of driverless vehicular systems, shopping centres, railway stations, airports, exhibition halls

MATERIAL

hot-dip galvanised steel substructure and high-grade steel V2A surface

COVERING TYPES

coating, concrete, screed, industrial covering, natural and stone slabs

TRAFFICABILITY

industrial trucks (lifting trucks, fork-lifts etc.), passenger car, trucks

FORMED PARTS

corner piece, T piece, cross piece, transition floor to wall

NOTES

We recommend that the customer applies grout between profile and covering so as to avoid typical hairline cracks.

This joint profile is also in black steel available.

Technical data

Movement horizontal:	35 mm (-15/+20 mm)
Visible width:	230 mm
Maximal joint width:	90 mm
Load rating:	wheel load 3500 kg up to Ø 150 mm, B = 100 mm
Load rating trucks:	600 kN (DIN 1072)
Load rating forklifts:	120 kN (DIN 1055-3)
Supply length:	3 mtr

Designs

Article No.	Profile height (h)	Recess(WxD)
VA.6.230/33	33 mm	370 x 43 mm
VA.6.230/43	43 mm	370 x 53 mm
VA.6.230/55	55 mm	370 x 65 mm
VA.6.230/65	65 mm	370 x 75 mm
VA.6.230/80	80 mm	370 x 90 mm
Special heights on request.		

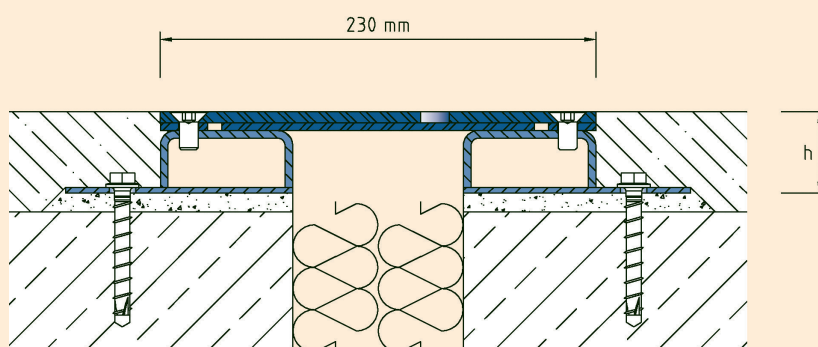

Subject to technical change without notice.

VA.6.230